









This larger than average two bedroom bay windowed Edwardian mid terraced cottage offers a wonderful living space ideal for first time buyers and those looking to downsize.

Decorated to a very good standard throughout and boasting a well proportioned dining kitchen, the property features accommodation comprising an entrance lobby, reception hall, living room, two bedrooms and a bathroom, whilst a courtyard to the rear provides secure off street parking accessed via remote control electric roller shutter door. Benefitting from gas central heating and UPVC double glazing.

The property enjoys a convenient position set close to a superb range of urban amenities including the Stadium Of Light Metro Station, Fulwell Road and Sea Road shopping centre, whilst the Sea Front and Roker Park are also within easy walking distance. Internal inspection unrevivably recommended!

MAIN ROOMS AND DIMENSIONS

Ground Floor

UPVC double glazed feature door to

Entrance Lobby

Part glazed door to reception hall.

Reception Hall



With contemporary style laminate flooring, radiator, coved cornicing to ceiling.

Bedroom 1 (front) 14'4" x 13'5"



UPVC double glazed bay window to front elevation with original architraving, double radiator.

Bedroom 2 (rear) 6'5" x 10'0"



UPVC double glazed windows to rear elevation, single radiator and contemporary style laminate flooring.

Lounge 12'8" x 13'8"



UPVC double glazed window to rear elevation, double radiator, contemporary style laminate flooring, electric wood burning effect stove set with an Inglenook, wall preparation for flat screen TV, wall lights, part glazed door to kitchen.

Dining Kitchen 9'6" x 22'5"



A selection of base and eye level unit with marble coloured working surfaces, incorporating a single drainer sink unit with pedestal mixer tap, integrated appliances include a five burner range oven with overhead extractor hood, and housing is provided for an American style fridge freezer

together with housing and plumbing for an automatic washing machine, a cupboard discreetly conceals a Baxi Duo Tech combination boiler serving hot water and radiators, tiled floor, wall mounted contemporary style column radiator, attractive tiled splashbacks, UPVC double glazed window and French doors leading out into the rear courtyard, breakfast bar, peninsular, second double radiator and wall preparation for flat screen TV.

Bathroom



Low level WC, washbasin set into vanity unit with pedestal mixer tap, free standing contemporary style double ended bath with wall mounted pedestal mixer tap with shower - attractive white suite with tiled floor, split faced tiled feature wall, halogen downlights, UPVC double glazed window to side elevation, double radiator.

Outside



Forecourt to front, enclosed courtyard to the rear, secure off street parking accessed via remote control electric roller shutter door.

Council Tax Band

The Council Tax Band is Band A.

Tenure Freehold

We are advised by the Vendors that the property is Freehold. Any prospective purchaser should clarify this with their Solicitor.

Visit www.peterheron.co.uk or call 0191 510 3323

Tried. Trusted. Recommended. City Branch 20 Fawcett Street Sunderland SR1 1RH Fulwell Branch 15 Sea Road Fulwell Sunderland SR6 9BS

MAIN ROOMS AND DIMENSIONS

Important Notice - Particulars

Peter Heron Ltd for themselves and for the vendors of this property whose agents they are, give notice that:- The particulars are set out for general guidance only for the intending Purchasers and do not constitute part of an offer or contract. Whilst we endeavour to make our sales particulars accurate and reliable, if there is anything of particular importance which you feel may influence your decision to purchase, please contact the office and we will be pleased to check the information. Do so particularly, if contemplating travelling some distance to view the property. All descriptions, dimensions, references to conditions and necessary permissions for use and occupation and other details are given in good faith, and are believed to be correct, however any intending purchasers should not rely on them that statements are representations of fact, but must satisfy themselves by inspection or otherwise as to the correctness of each of them. Independent property size verification is recommended.

Lease details, service charges and ground rent (where applicable) are given as a guide only and should be checked and confirmed by your Solicitor prior to exchange of contracts. No person in the employment of Peter Heron Ltd has any authority to make or give any representation or warranty whatever in relation to this property or these particulars, nor to enter into any contract on behalf of Peter Heron Ltd, nor into any contract on behalf of the Vendor. The copyright of all details and photographs remain exclusive to Peter Heron Ltd.

Please note that in the event the purchaser uses the services of Peter Heron Conveyancing in the purchase of their home, Peter Heron Ltd will be paid a completion commission of £300.00 by Movewithus Ltd.

Sea Road Viewings

To arrange an appointment to view this property please contact our Sea Road branch on 0191 510 6116 or book viewing online at peterheron.co.uk

Opening Times

Monday to Friday 9.00am - 5.00pm Saturday 9.00am - 12noon

Ombudsman

Peter Heron Estate Agents are members of The Property Ombudsman and subscribe to The Property Ombudsman Code of Practice.

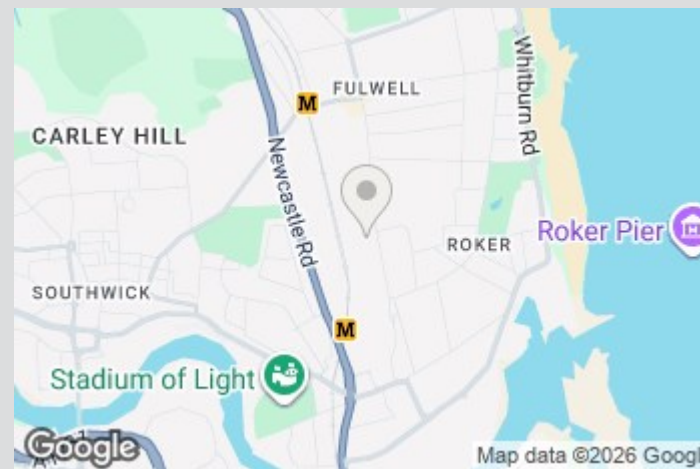
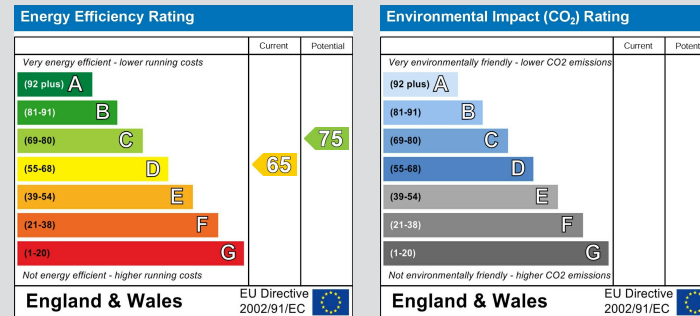

Visit www.peterheron.co.uk or call 0191 510 3323

Tried. Trusted. Recommended. City Branch 20 Fawcett Street Sunderland SR1 1RH Fulwell Branch 15 Sea Road Fulwell Sunderland SR6 9BS

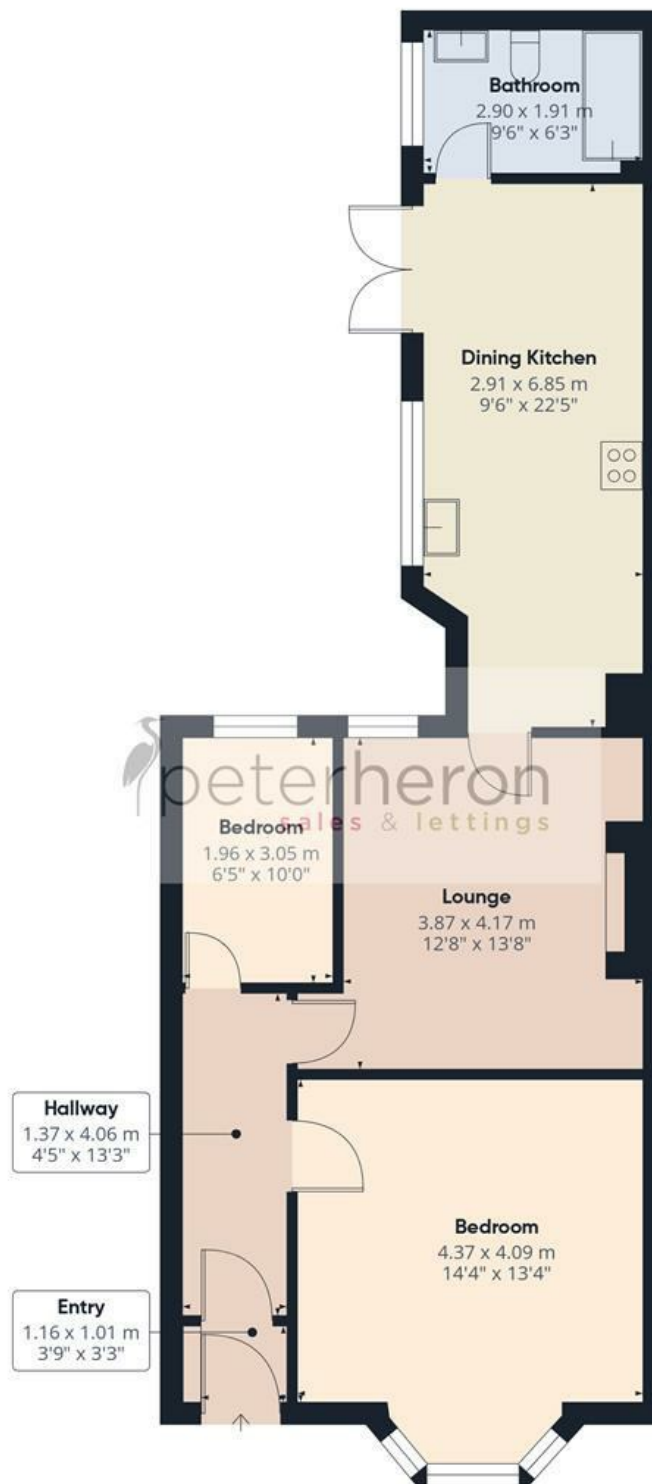

Approximate total area⁽¹⁾

73 m²

786 ft²

(1) Excluding balconies and terraces

Calculations reference the RICS IPMS 3C standard. Measurements are approximate and not to scale. This floor plan is intended for illustration only.

GIRAFFE360

